

Technical Data:

Material:

- Solder Pin: Brass or Copper Alloy with Tin plated
- Insulator body(housing): Polyamide(PA66)(UL94V-0)

Electrical

- Voltage rating: 300VAC
- Current rating: 20A
- Insulation resistance: 500MΩ at DC 500V
- Withstanding Voltage: AC 2500V(1min)

Mechanical:

- Using temperature Range: -40°C to +115°C
- Soldering temperature: +250°, 5seconds Max.

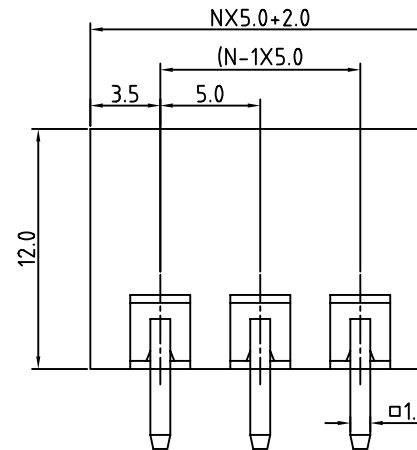
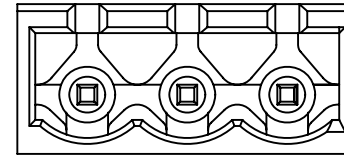

N=Number of contacts

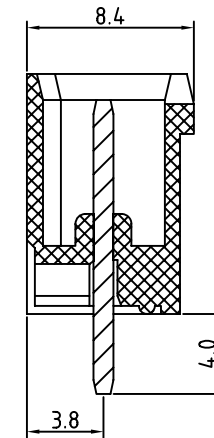

P.C.B. LAYOUT

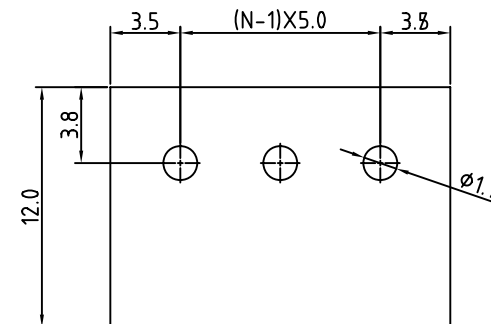

**AAA**CONN

AAA (HK) Electronics Co., Ltd.

www.aaaconnectors.com

**RoHS Compliant**

TOLERANCES ARE

DRAWING BY	X. ±
CHECKED BY	.X ±
UNIT / mm	.XX ±
SCALE 1 : 1	.XXX ±
DATE	ANG ±

SIZE A4 PPROJECTION

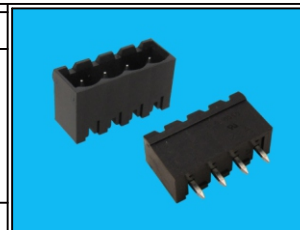

**ORDER INFORMATION**

TBHV-500-xx-xx

SERIES

INSULATOR COLOR : 1=GREEN, 2=BLACK, 3=BLUE, 4=GREY

CONTACT : 1=BRASS, 2=COPPER ALLOY

POLES : 02-24

PITCH : 5.00mm

Description: Terminal Block Header Male Pins Vertical 5.00mm Through Hole